

Quick Installation Guide

RPM Console Manager

The following instructions will help you install and connect your **RPM Console Manager (CM)**. Should you require further assistance, please contact Uptime Devices Technical Support.

1 Rack mounting the sensor hub

The RPM CM can be installed in a 19" rack cabinet. Secure the rack wings to either the front or back end of the RPM CM.

2 Connecting to your network

Connect one end of an ethernet cable into an available 10 or 100 mb port on your network. Plug the other end into the ethernet port on the back of the sensor hub. The ethernet LED will illuminate when a valid connection is established. **Optional:** Using a CAT 5 cable and a RJ-45 to DB-9F adaptor connect a modem to the SMS modem port on the back of the RPM CM

3 Connecting RIMS

Using a CAT 5 straight through cable, connect a Remote Intelligent Multi Sensor (RIMS) to any of the four RJ45 ports located on the back of the RPM CM. RIMS will automatically be discovered and added to the list of available sensors on the RPM CM.

4 Daisy chaining RIMS

Each RIMS has a second port that can be used for daisy chaining other RIMS. Use a CAT 5 straight through cable to chain additional RIMS.

5 Connecting the power cable

Plug one end of the the power cable into the RPM CM and the other into a matching receptacle.

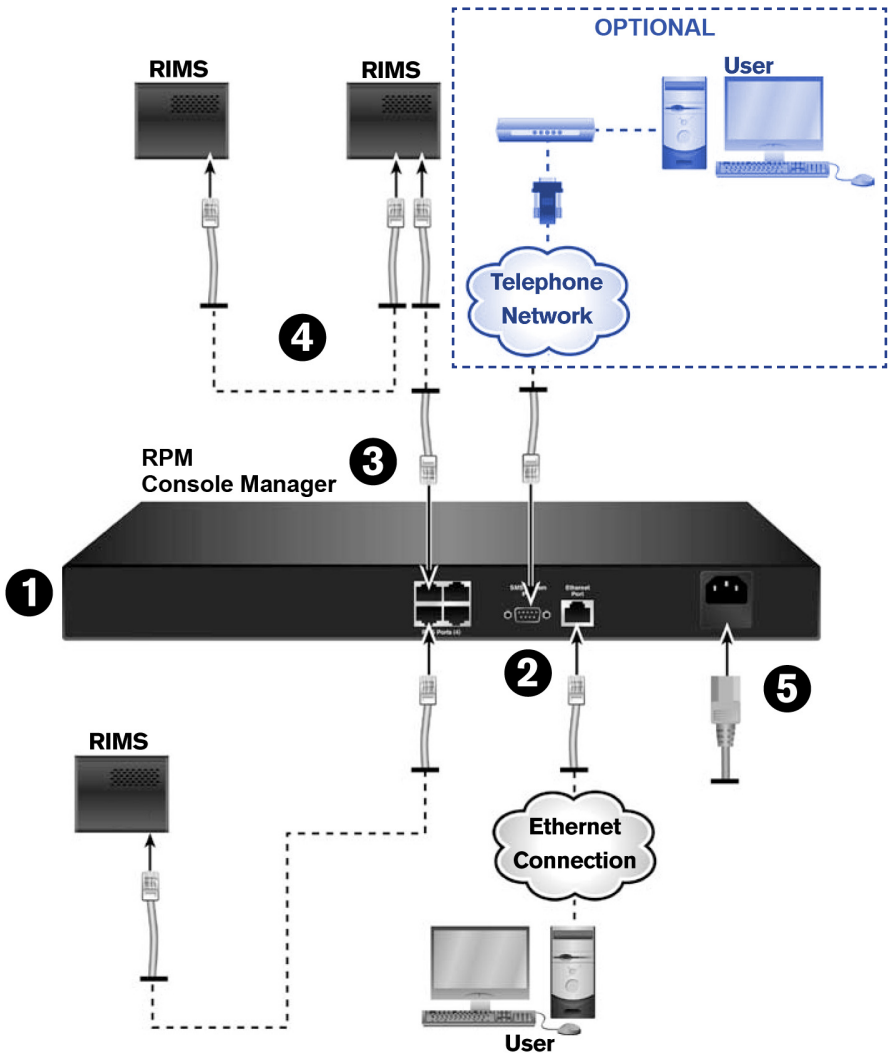

For technical support, visit <http://www.uptimedevices.com/support.php>